

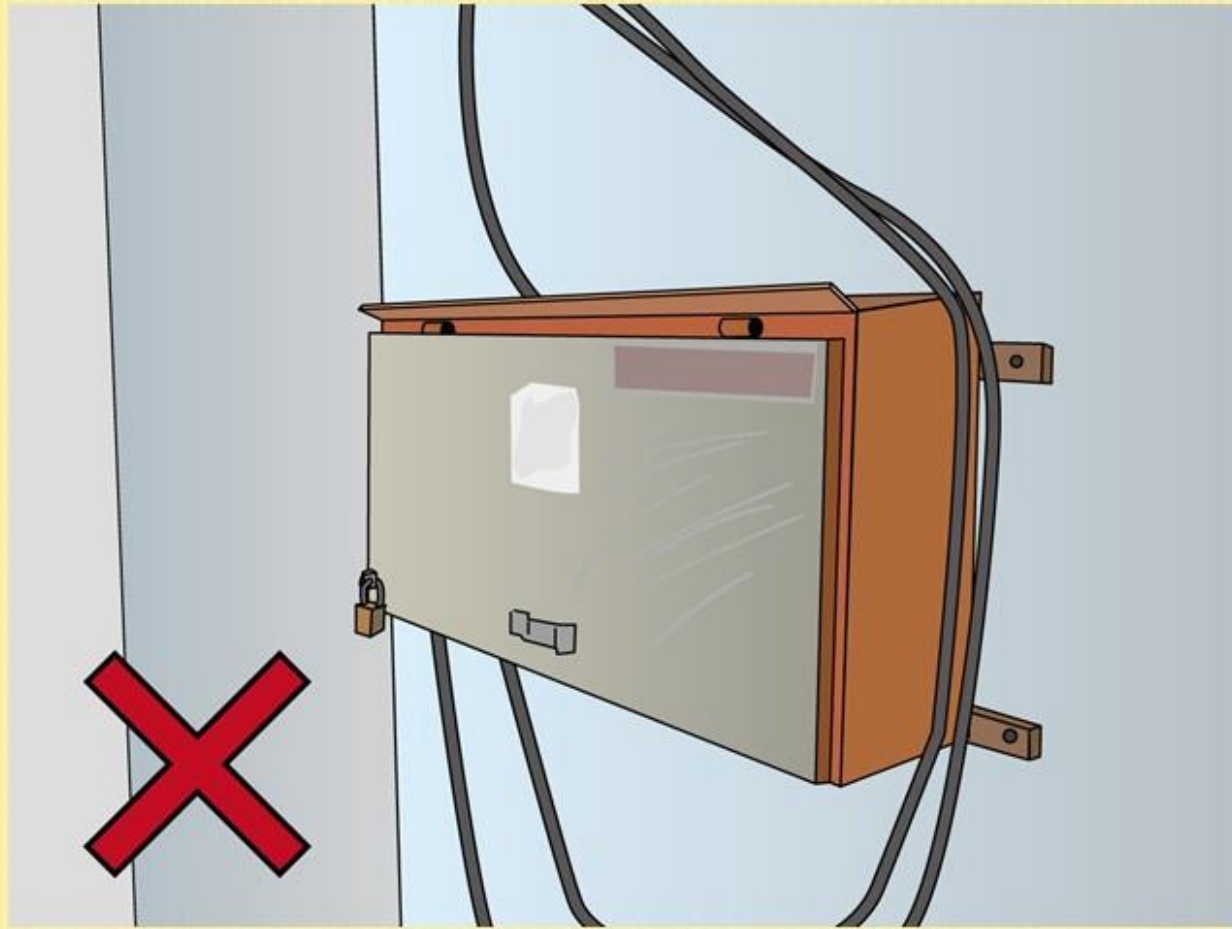

ELECTRICAL SUPPLY SYSTEM
供电系统

67

未有张贴电擊告示、注册电工等数据 NOTICE OF ELECTRIC SHOCK, REW NAMES AND CONTACT NOT DISPLAYED



电源线插头损坏。110V 的插头连接到 220V 的插座。

CORD GUARDS WERE DAMAGED AND IMPROPER CONNECTION OF SOCKET PLUG.

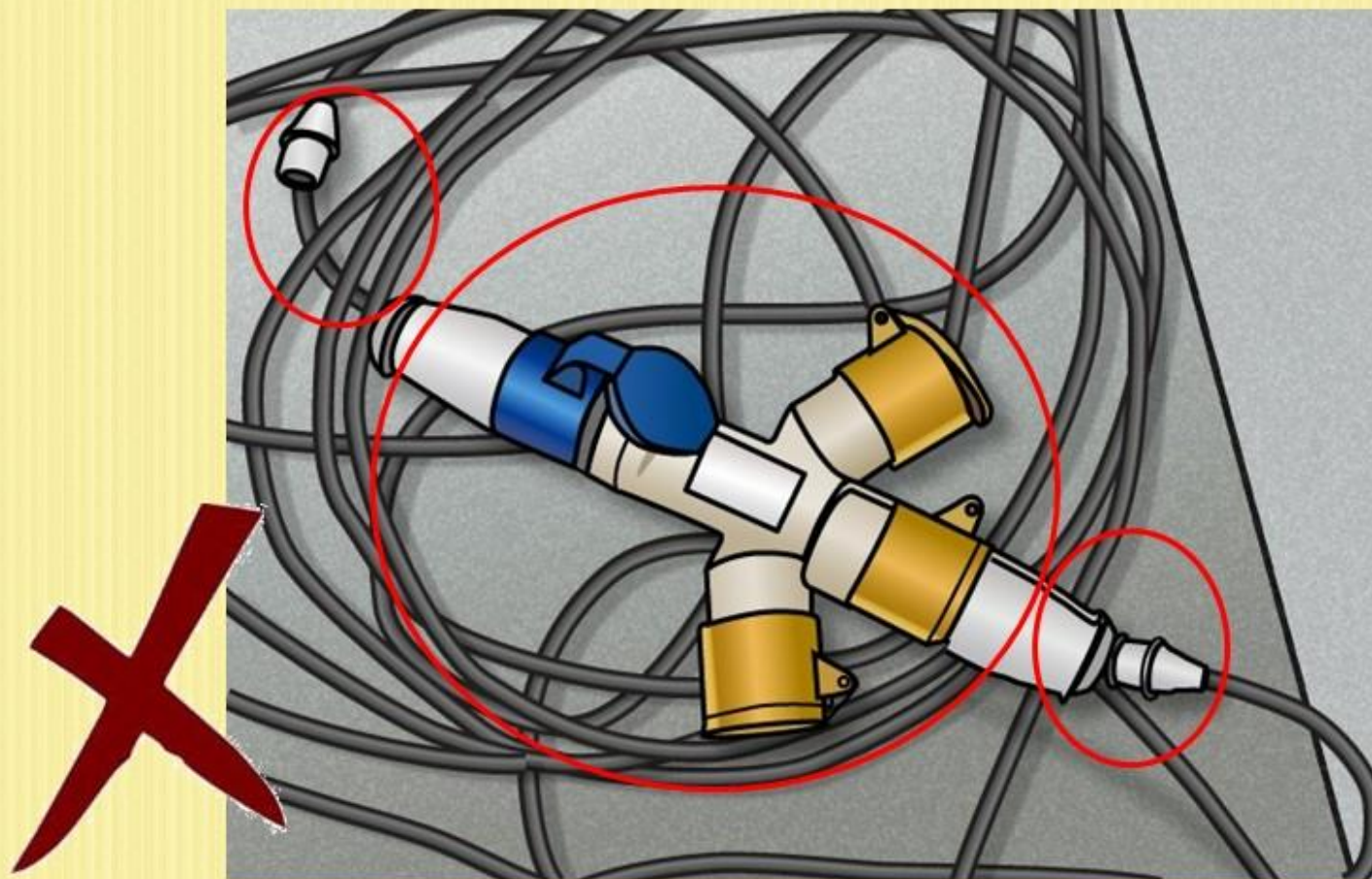

220V的手提工具使用110V的插头。

220V HAND-HELD TOOLS WERE FOUND WITH 110V SOCKET.

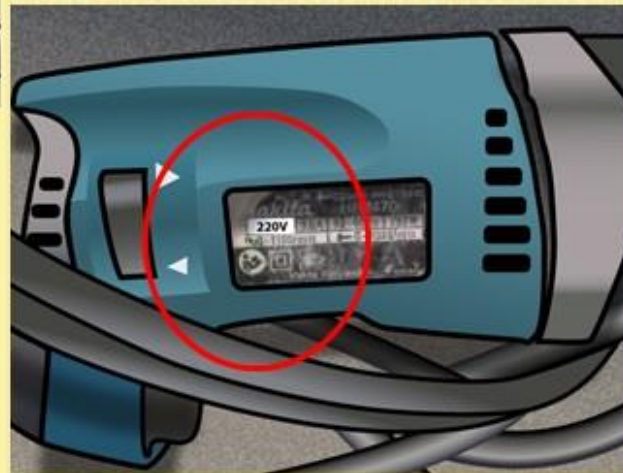
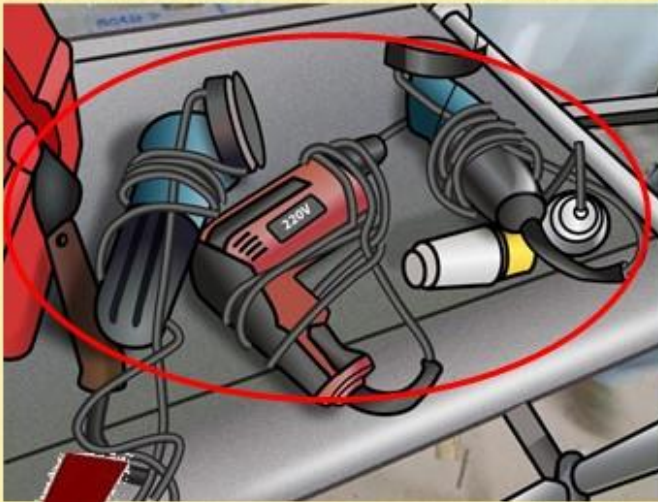

电线拖地，有绊倒的危险。

TRIPPING HAZARD WAS FOUND FOR THE TRAILING CABLE. TRAILING CABLE WAS FOUND.



机手可能看不清楚泥坑内情况，但工友在没有讯号员的情况下在泥坑内工作。

OPERATOR OF THE EXCAVATOR MAY NOT HAVE UNOBSTRUCTED VIEW OF THE WHOLE PIT AND THE MOVING BUCKET MAY HIT THE WORKER. WORKER SHOULD AVOID WORKING IN EXCAVATION WHEN EXCAVATOR IS OPERATING NEARBY WITHOUT A SIGNALLER.

