

## 樓宇樣本平面圖

彩明苑彩柳閣 (B座) 1樓至40樓

## Typical Floor Plan

Choi Ming Court Choi Lau House (Block B)  
1/F-40/F

### 樓宇樣本平面圖

A座及B座1樓至40樓

康和式一型設計

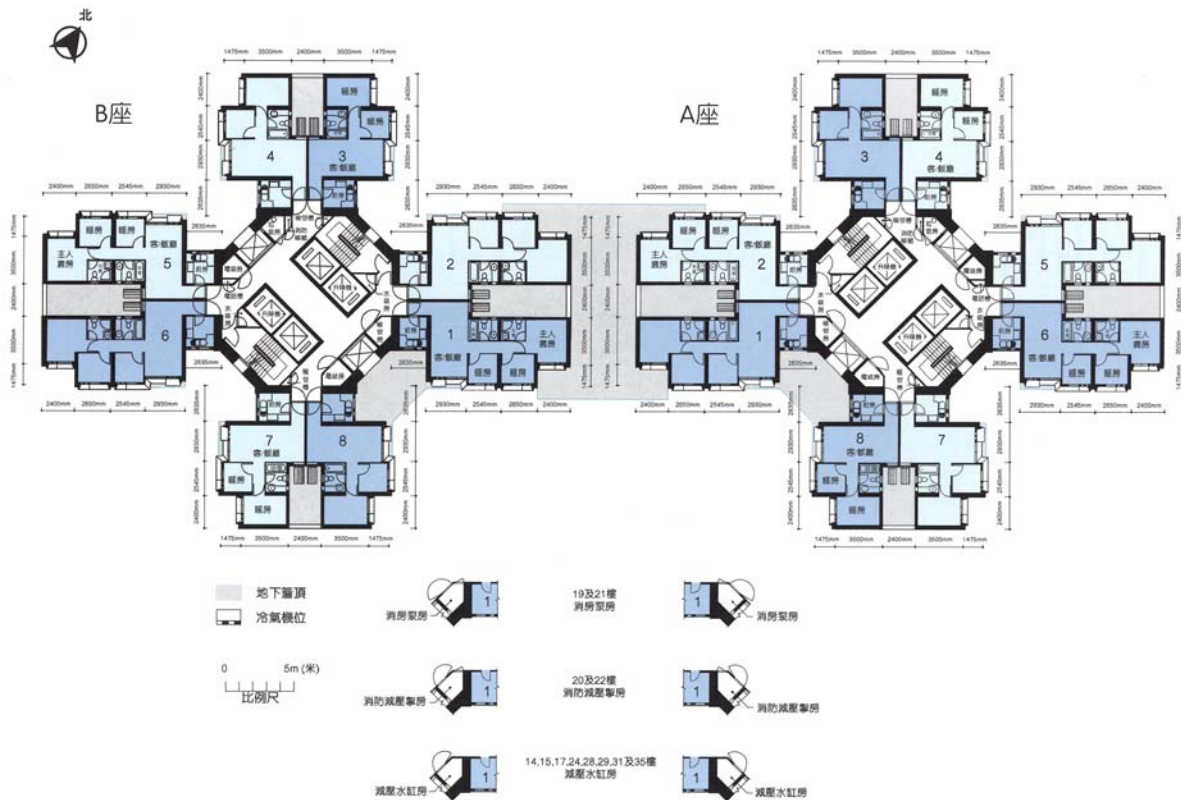

樓宇樣本平面圖、附圖摘錄自 2010 年 5 月印製的出售剩餘居屋單位第 6 期的彩明苑資料摘要,只供參考。擬購買單位人士在購買單位前,應實地參觀並了解擬選購單位的現狀。

The typical floor plan, part plan are extracted from the information brochure of Choi Ming Court under the Sale of Surplus Home Ownership Scheme Flats Phase 6 printed in May 2010 and are for reference only. Prior to purchasing a flat, prospective purchaser should carry out on-the-spot visit to get to know the existing condition of the flat.