

樓宇樣本平面圖
顯明苑 1 樓至 38 樓

Typical Floor Plan
Hin Ming Court 1/F-38/F

1樓至38樓

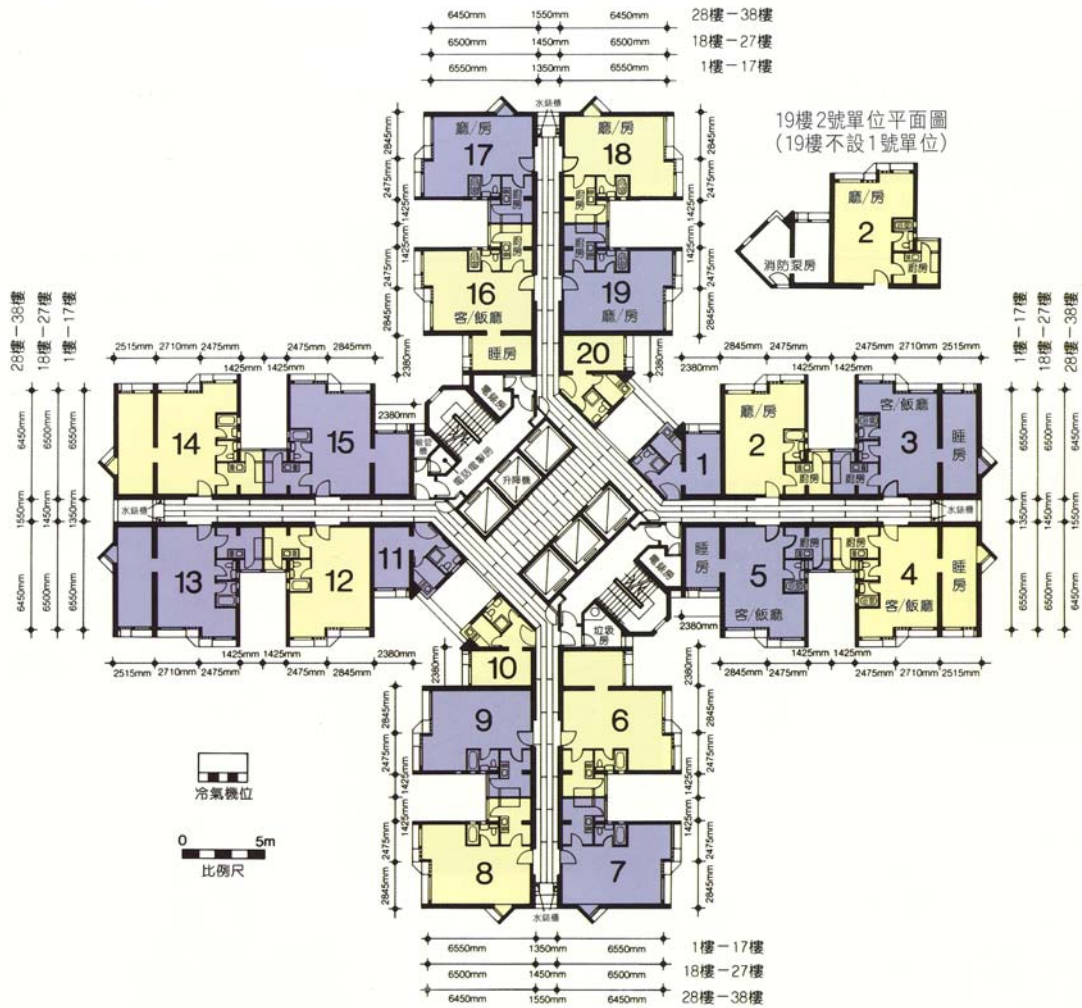

樓宇樣本平面圖、附圖摘錄自 2008 年 1 月印製的出售剩餘居屋單位第 3 期的顯明苑資料摘要,只供參考。擬購買單位人士在購買單位前,應實地參觀並了解擬選購單位的現狀。

The typical floor plan, part plan are extracted from the information brochure of Hin Ming Court under the Sale of Surplus Home Ownership Scheme Flats Phase 3 printed in January 2008 and are for reference only. Prior to purchasing a flat, prospective purchaser should carry out on-the-spot visit to get to know the existing condition of the flat.