

樓宇樣本平面圖

荔欣苑荔影閣 (A座) 1樓至40樓

Typical Floor Plan

Lai Yan Court Lai Ying House (Block A)

1/F-40/F

A座1樓至40樓 (和諧式)

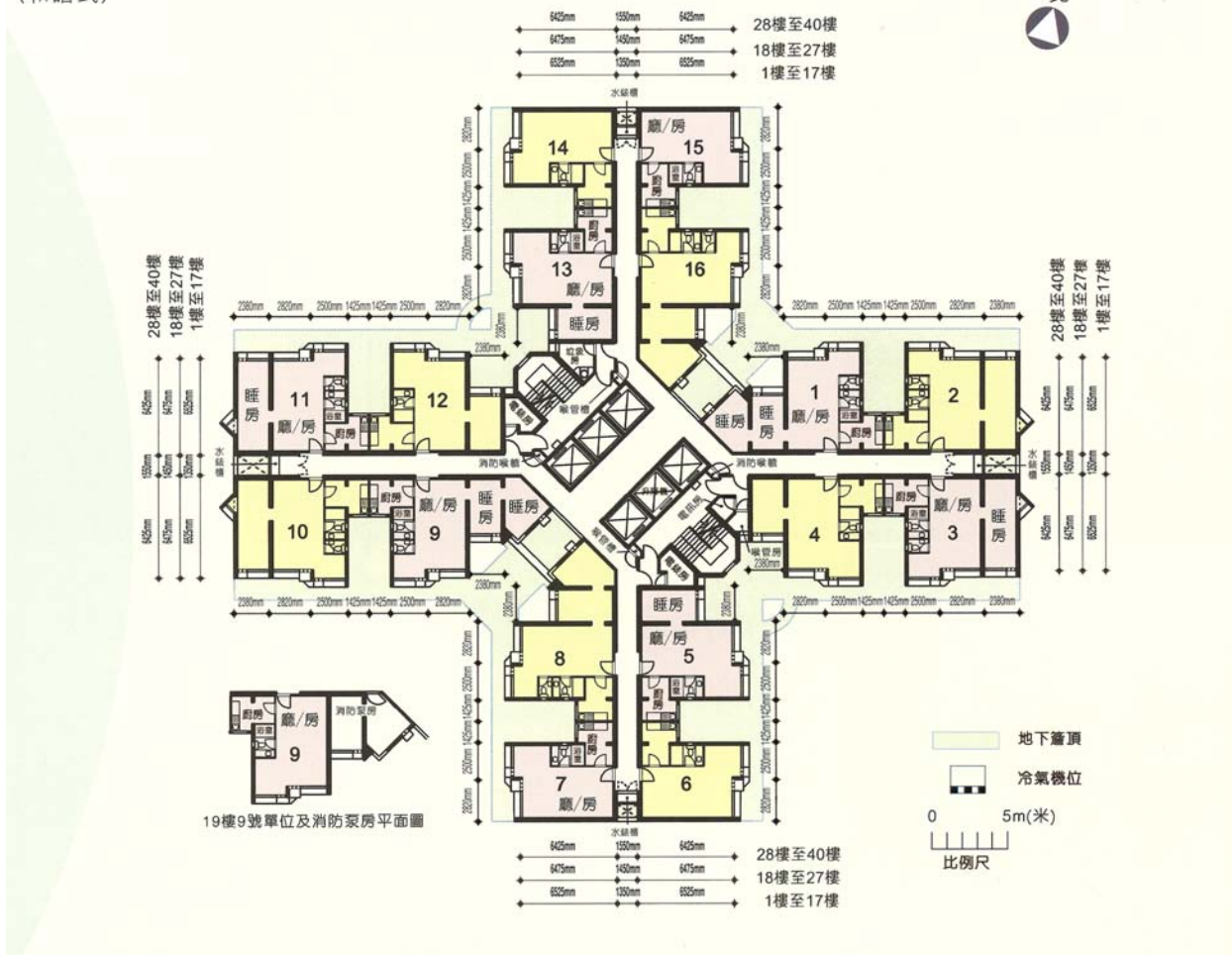

樓宇樣本平面圖、附圖摘錄自 2008 年 8 月印製的出售剩餘居屋單位第 4 期的荔欣苑資料摘要,只供參考。擬購買單位人士在購買單位前,應實地參觀並了解擬選購單位的現狀。

The typical floor plan, part plan are extracted from the information brochure of Lai Yan Court under the Sale of Surplus Home Ownership Scheme Flats Phase 4 printed in August 2008 and are for reference only. Prior to purchasing a flat, prospective purchaser should carry out on-the-spot visit to get to know the existing condition of the flat.