

## 樓宇樣本平面圖

兆軒苑順生閣 (A座) 1樓至34樓

## Typical Floor Plan

Siu Hin Court Shun Sang House (Block A)  
1/F-34/F

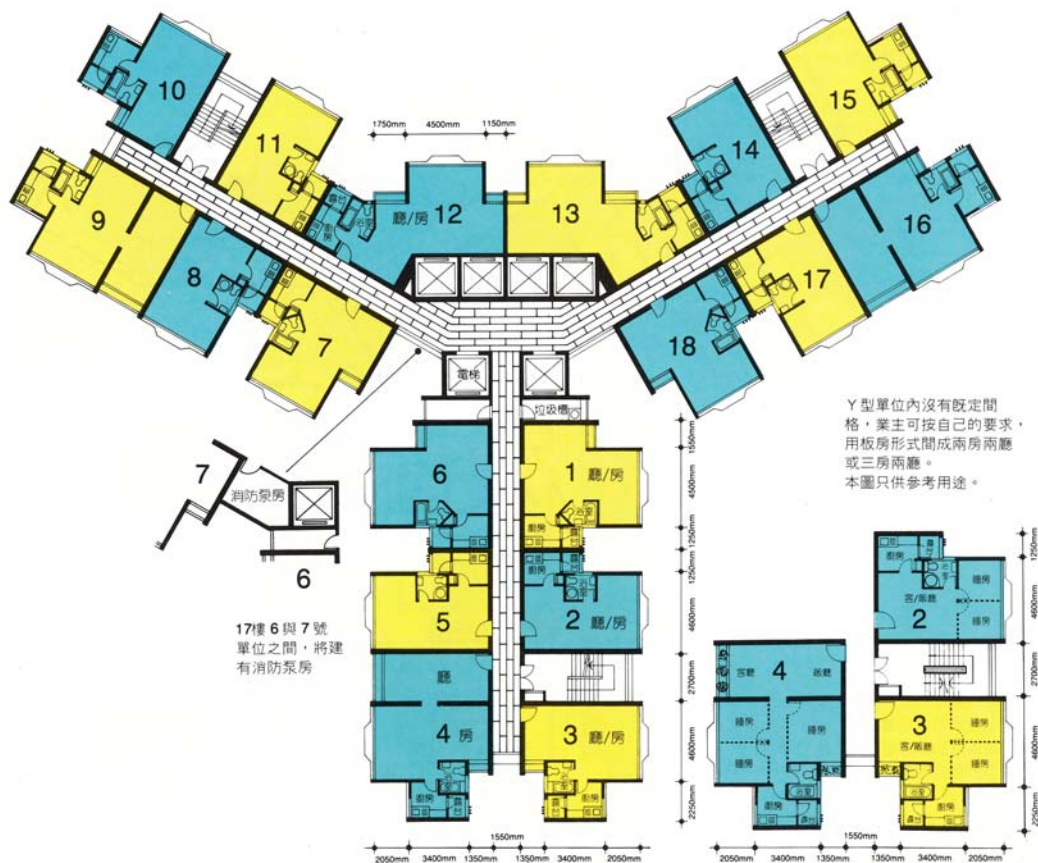

樓宇樣本平面圖、附圖摘錄自1990年12月印製的居者有其屋計劃第12期丙的兆軒苑資料摘要，只供參考。擬購買單位人士在購買單位前，應實地參觀並了解擬選購單位的現狀。

The typical floor plan, part plan are extracted from the information brochure of Siu Hin Court under the Home Ownership Scheme Phase 12C printed in December 1990 and are for reference only. Prior to purchasing a flat, prospective purchaser should carry out on-the-spot visit to get to know the existing condition of the flat.