

屋邨的住宅物業的樓面平面圖  
Floor Plans of Residential Properties in the Estate

德隆樓(第8座)  
1樓平面圖  
TAK LUNG HOUSE (BLOCK 8)  
1/F FLOOR PLAN

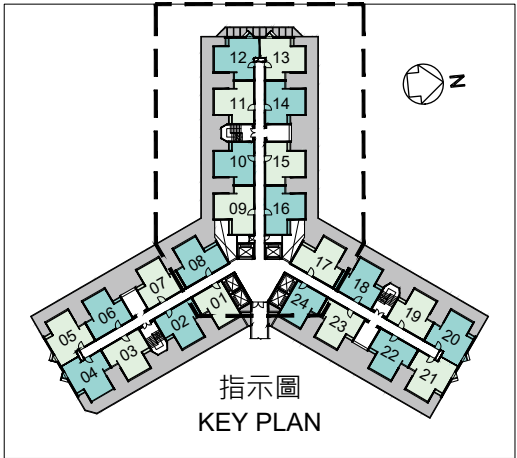

比例尺SCALE: 0 5(米)  
(m)

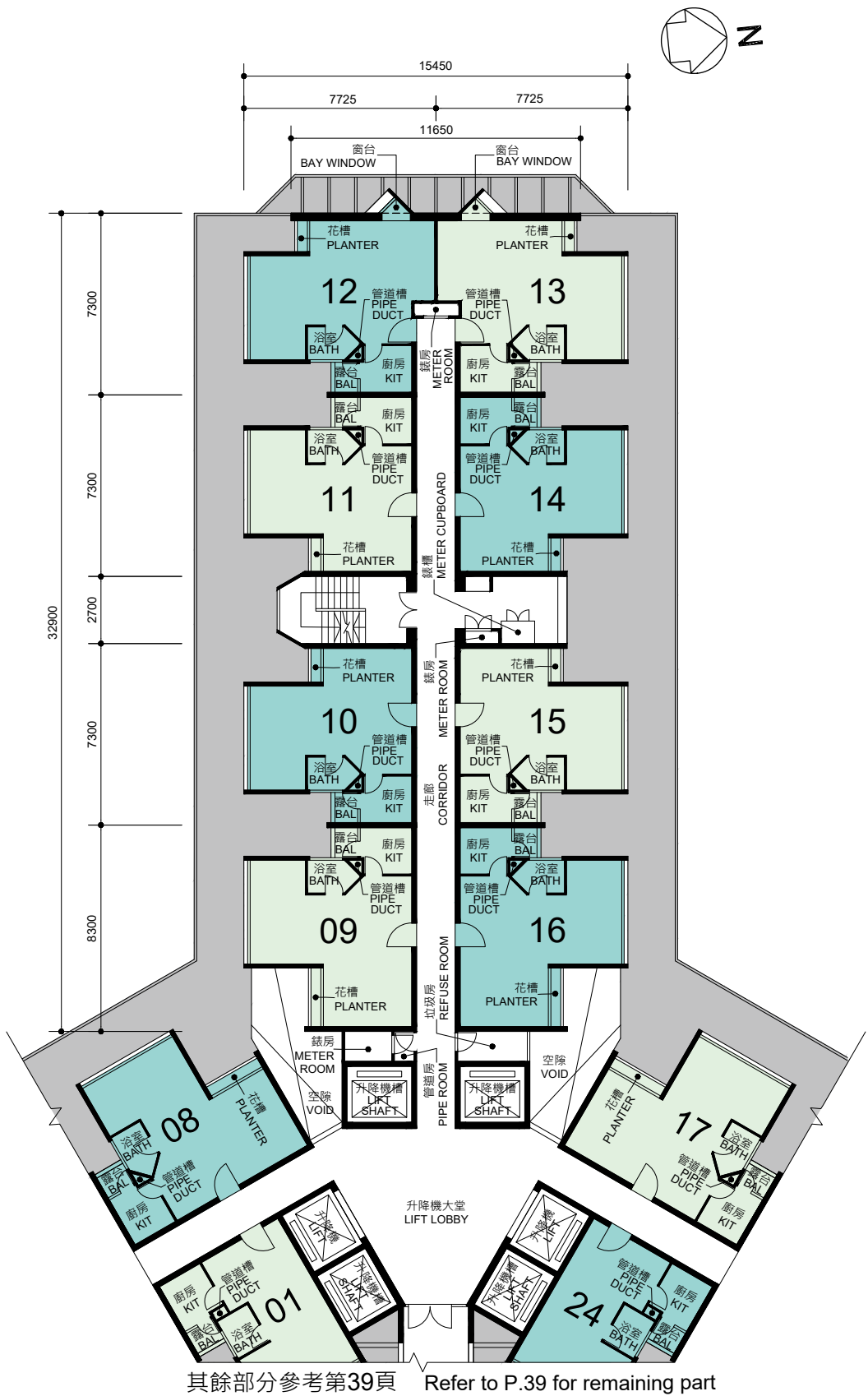

圖例 NOTATION

BATH	浴室	Bathroom
KIT	廚房	Kitchen
BAL	露台	Balcony
	簷篷 / 平台 / 傾斜天面	Canopy / Flat Roof / Sloping Roof

- 註：
1. 本圖參考備存於運輸及房屋局常任秘書長(房屋)辦公室的獨立審查組的資料紀錄製作，有需要處經修正處理。
  2. 本圖只用作顯示租置計劃回收單位(下稱「回收單位」)在樓宇內的位置和界線，並不在反映回收單位、其他住宅單位及樓宇目前的實際情況及狀況。回收單位或其他住宅單位內外的現場布局及樓宇內的公眾設施可能與這些資料紀錄及本圖有所不同。買方可參考由房委會於選購單位期間提供的回收單位照片和錄像短片(如有)，以便對回收單位有較佳的了解。
  3. 房委會並不負責管理該屋邨的公眾地方及設施，以及已經出售的住宅單位。回收單位是按「現有」狀況及其現時的實際情況及狀況出售。房委會沒有亦不會就該屋邨的公眾地方及設施、回收單位內外的裝修、布局、尺寸、實際情況及狀況作出任何保證。買方應到該屋邨作實地考察，以對該屋邨、其周邊環境及公共設施有較佳的了解。
  4. 本圖所列之數字為以毫米標示之尺寸。
  5. 大廈設有6部升降機，每個住宅樓層均有2部升降機到達。
  6. 大廈1至2樓單位前身為長者住屋，部份單位至今仍屬長者住屋。該些單位的信箱設於與單位同層的升降機大堂內。

- Notes：
1. This plan is prepared with reference to the records kept by the Independent Checking Unit of the Office of the Permanent Secretary for Transport and Housing (Housing), with adjustments where necessary.
  2. This plan is for identifying the locations and boundaries of the recovered TPS flats in the blocks only and does not aim to reflect the prevailing physical state and condition of the recovered TPS flats, other residential flats and the blocks. The existing layouts inside and outside the recovered TPS flats or other residential flats and the common facilities in the blocks may differ from these records and this plan. Purchasers may refer to the photos and videos (if any) provided by the HA during the flat selection period for a better understanding of the recovered TPS flats.
  3. The HA is not responsible for the management of the common parts and facilities of the estate and those sold residential flats. The recovered TPS flats are sold on an "as-is" basis and in the physical state and condition as they stand. No warranty whatsoever has been given or is made by the HA regarding the common parts and facilities of the estate, and the decoration, layout, dimensions, physical state and condition inside and outside the recovered TPS flats. Purchasers should conduct an on-site visit for a better understanding of the estate, its surrounding environment and the public facilities.
  4. The dimensions on the floor plan are all in millimetres.
  5. There are 6 lifts in the building, each residential floor is served by 2 lifts.
  6. Flats on the 1/F and 2/F were former Housing for Senior Citizens and some of them remain unchanged. Letter boxes of these flats are provided at the lift lobbies on the same floors of the flats.

樓宇平面圖摘錄自為出售租者置其屋計劃屋邨回收單位而於2021年9月印製的德田邨售樓小冊子，只供參考。個別樓層（如平面圖覆蓋多於一樓層）或單位的圖則跟上述平面圖或有差異，擬於居屋第二市場購買單位人士在購買單位前，應實地參觀並了解擬選購單位的現狀。  
The floor plan is extracted from the sales pamphlet of Tak Tin Estate printed in September 2021 for the sale of Recovered Flats from Estates under Tenants Purchase Scheme and is for reference only. The plan of individual floor (if the floor plan covers more than one floor) or flat may vary from the above floor plan. Prior to purchasing a flat in the HOS Secondary Market, prospective purchaser should carry out on-the-spot visit to get to know the existing condition of the flat.

屋邨的住宅物業的樓面平面圖  
Floor Plans of Residential Properties in the Estate

德隆樓(第8座)  
1樓平面圖  
TAK LUNG HOUSE (BLOCK 8)  
1/F FLOOR PLAN



- 註：
1. 本圖參考備存於運輸及房屋局常任秘書長(房屋)辦公室的獨立審查組的資料紀錄製作，有需要處經修正處理。
  2. 本圖只用作顯示租置計劃回收單位(下稱「回收單位」)在樓宇內的位置和界線，並不旨在反映回收單位、其他住宅單位及樓宇目前的實際情況及狀況。回收單位或其他住宅單位內外的現場布局及樓宇內的公眾設施可能與這些資料紀錄及本圖有所不同。買方可參考由房委會於選購單位期間提供的回收單位照片和錄像短片(如有)，以便對回收單位有較佳的了解。
  3. 房委會並不負責管理該屋邨的公眾地方及設施，以及已經出售的住宅單位。回收單位是按「現有」狀況及其現時的實際情況及狀況出售。房委會沒有亦不會就該屋邨的公眾地方及設施、回收單位內外的裝修、布局、尺寸、實際情況及狀況作出任何保證。買方應到該屋邨作實地考察，以對該屋邨、其周邊環境及公共設施有較佳的了解。
  4. 本圖所列之數字為以毫米標示之尺寸。
  5. 大廈設有6部升降機，每個住宅樓層均有2部升降機到達。
  6. 大廈1至2樓單位前身為長者住屋，部份單位至今仍屬長者住屋。該些單位的信箱設於與單位同層的升降機大堂內。

- Notes :
1. This plan is prepared with reference to the records kept by the Independent Checking Unit of the Office of the Permanent Secretary for Transport and Housing (Housing), with adjustments where necessary.
  2. This plan is for identifying the locations and boundaries of the recovered TPS flats in the blocks only and does not aim to reflect the prevailing physical state and condition of the recovered TPS flats, other residential flats and the blocks. The existing layouts inside and outside the recovered TPS flats or other residential flats and the common facilities in the blocks may differ from these records and this plan. Purchasers may refer to the photos and videos (if any) provided by the HA during the flat selection period for a better understanding of the recovered TPS flats.
  3. The HA is not responsible for the management of the common parts and facilities of the estate and those sold residential flats. The recovered TPS flats are sold on an "as-is" basis and in the physical state and condition as they stand. No warranty whatsoever has been given or is made by the HA regarding the common parts and facilities of the estate, and the decoration, layout, dimensions, physical state and condition inside and outside the recovered TPS flats. Purchasers should conduct an on-site visit for a better understanding of the estate, its surrounding environment and the public facilities.
  4. The dimensions on the floor plan are all in millimetres.
  5. There are 6 lifts in the building, each residential floor is served by 2 lifts.
  6. Flats on the 1/F and 2/F were former Housing for Senior Citizens and some of them remain unchanged. Letter boxes of these flats are provided at the lift lobbies on the same floors of the flats.



屋邨的住宅物業的樓面平面圖  
Floor Plans of Residential Properties in the Estate

德隆樓(第8座)  
2樓平面圖  
TAK LUNG HOUSE (BLOCK 8)  
2/F FLOOR PLAN

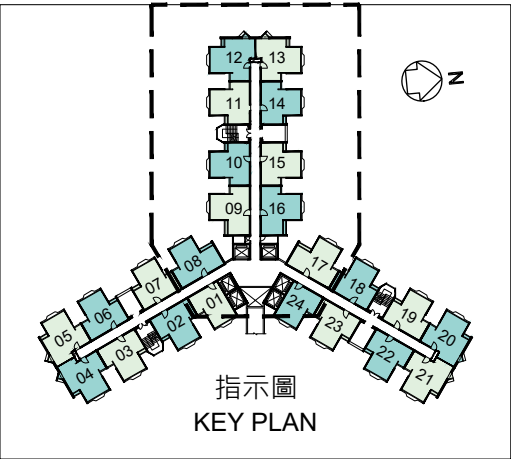

比例尺 SCALE: 0 5(米)  
(m)

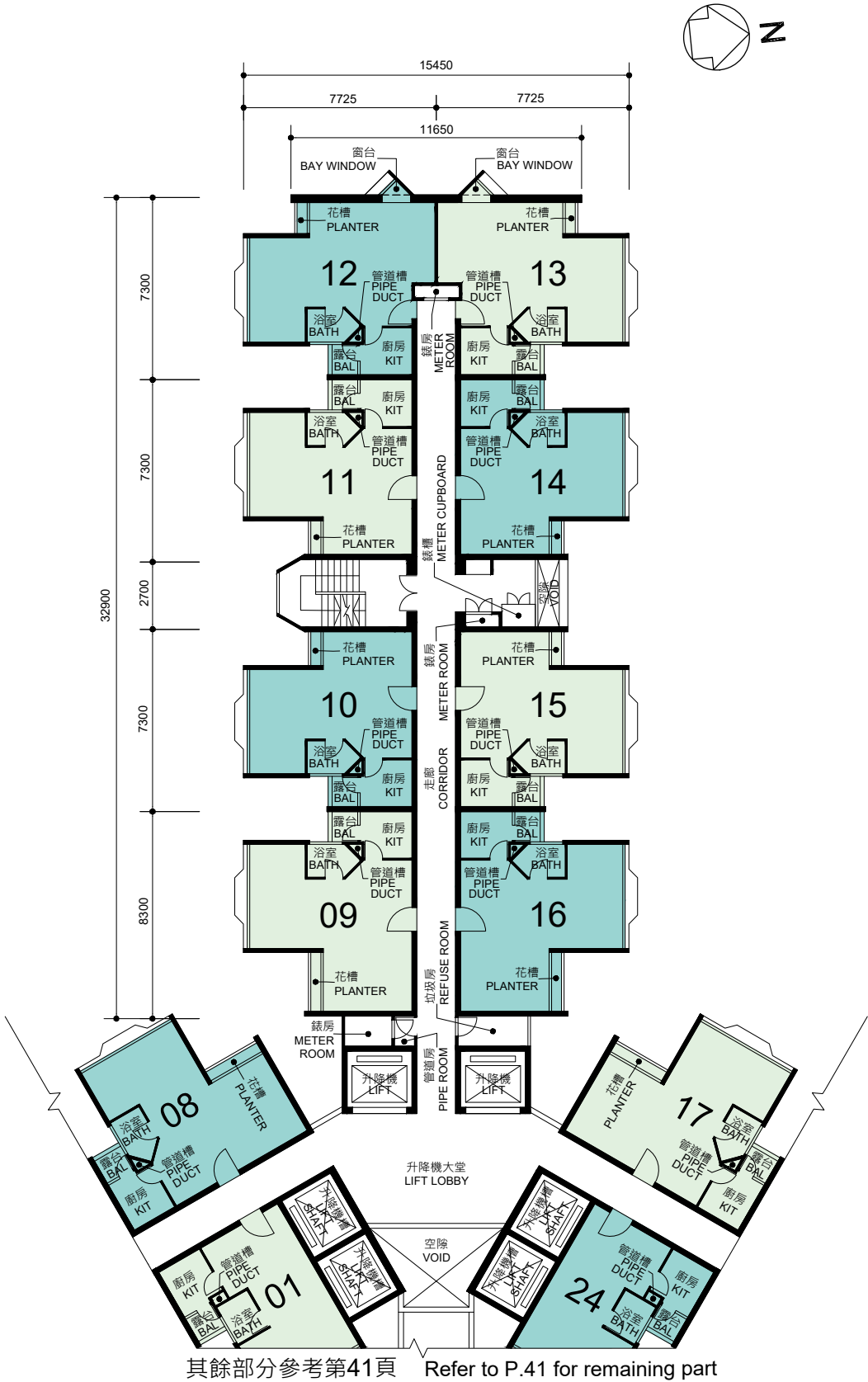

樓宇平面圖摘錄自為出售租者置其屋計劃屋邨回收單位而於2021年9月印製的德田邨售樓小冊子，只供參考。個別樓層（如平面圖覆蓋多於一樓層）或單位的圖則跟上述平面圖或有差異，擬於居屋第二市場購買單位人士在購買單位前，應實地參觀並了解擬選購單位的現狀。  
The floor plan is extracted from the sales pamphlet of Tak Tin Estate printed in September 2021 for the sale of Recovered Flats from Estates under Tenants Purchase Scheme and is for reference only. The plan of individual floor (if the floor plan covers more than one floor) or flat may vary from the above floor plan. Prior to purchasing a flat in the HOS Secondary Market, prospective purchaser should carry out on-the-spot visit to get to know the existing condition of the flat.

圖例 NOTATION

BATH	浴室	Bathroom
KIT	廚房	Kitchen
BAL	露台	Balcony

- 註：
1. 本圖參考備存於運輸及房屋局常任秘書長(房屋)辦公室的獨立審查組的資料紀錄製作，有需要處經修正處理。
  2. 本圖只用作顯示租置計劃回收單位(下稱「回收單位」)在樓宇內的位置和界線，並不在反映回收單位、其他住宅單位及樓宇目前的實際情況及狀況。回收單位或其他住宅單位內外的現場布局及樓宇內的公眾設施可能與這些資料紀錄及本圖有所不同。買方可參考由房委會於選購單位期間提供的回收單位照片和錄像短片(如有)，以便對回收單位有較佳的了解。
  3. 房委會並不負責管理該屋邨的公眾地方及設施，以及已經出售的住宅單位。回收單位是按「現有」狀況及其現時的實際情況及狀況出售。房委會沒有亦不會就該屋邨的公眾地方及設施、回收單位內外的裝修、布局、尺寸、實際情況及狀況作出任何保證。買方應到該屋邨作實地考察，以對該屋邨、其周邊環境及公共設施有較佳的了解。
  4. 本圖所列之數字為以毫米標示之尺寸。
  5. 大廈設有6部升降機，每個住宅樓層均有2部升降機到達。
  6. 大廈1至2樓單位前身為長者住屋，部份單位至今仍屬長者住屋。該些單位的信箱設於與單位同層的升降機大堂內。

- Notes :
1. This plan is prepared with reference to the records kept by the Independent Checking Unit of the Office of the Permanent Secretary for Transport and Housing (Housing), with adjustments where necessary.
  2. This plan is for identifying the locations and boundaries of the recovered TPS flats in the blocks only and does not aim to reflect the prevailing physical state and condition of the recovered TPS flats, other residential flats and the blocks. The existing layouts inside and outside the recovered TPS flats or other residential flats and the common facilities in the blocks may differ from these records and this plan. Purchasers may refer to the photos and videos (if any) provided by the HA during the flat selection period for a better understanding of the recovered TPS flats.
  3. The HA is not responsible for the management of the common parts and facilities of the estate and those sold residential flats. The recovered TPS flats are sold on an "as-is" basis and in the physical state and condition as they stand. No warranty whatsoever has been given or is made by the HA regarding the common parts and facilities of the estate, and the decoration, layout, dimensions, physical state and condition inside and outside the recovered TPS flats. Purchasers should conduct an on-site visit for a better understanding of the estate, its surrounding environment and the public facilities.
  4. The dimensions on the floor plan are all in millimetres.
  5. There are 6 lifts in the building, each residential floor is served by 2 lifts.
  6. Flats on the 1/F and 2/F were former Housing for Senior Citizens and some of them remain unchanged. Letter boxes of these flats are provided at the lift lobbies on the same floors of the flats.

樓宇平面圖摘錄自為出售租者置其屋計劃屋邨回收單位而於2021年9月印製的德田邨售樓小冊子，只供參考。個別樓層（如平面圖覆蓋多於一樓層）或單位的圖則跟上述平面圖或有差異，擬於居屋第二市場購買單位人士在購買單位前，應實地參觀並了解擬選購單位的現狀。

The floor plan is extracted from the sales pamphlet of Tak Tin Estate printed in September 2021 for the sale of Recovered Flats from Estates under Tenants Purchase Scheme and is for reference only. The plan of individual floor (if the floor plan covers more than one floor) or flat may vary from the above floor plan. Prior to purchasing a flat in the HOS Secondary Market, prospective purchaser should carry out on-the-spot visit to get to know the existing condition of the flat.

屋邨的住宅物業的樓面平面圖  
Floor Plans of Residential Properties in the Estate

德隆樓(第8座)  
2樓平面圖  
TAK LUNG HOUSE (BLOCK 8)  
2/F FLOOR PLAN



- 註：
1. 本圖參考備存於運輸及房屋局常任秘書長(房屋)辦公室的獨立審查組的資料紀錄製作，有需要處經修正處理。
  2. 本圖只用作顯示租置計劃回收單位(下稱「回收單位」)在樓宇內的位置和界線，並不旨在反映回收單位、其他住宅單位及樓宇目前的實際情況及狀況。回收單位或其他住宅單位內外的現場布局及樓宇內的公眾設施可能與這些資料紀錄及本圖有所不同。買方可參考由房委會於選購單位期間提供的回收單位照片和錄像短片(如有)，以便對回收單位有較佳的了解。
  3. 房委會並不負責管理該屋邨的公眾地方及設施，以及已經出售的住宅單位。回收單位是按「現有」狀況及其現時的實際情況及狀況出售。房委會沒有亦不會就該屋邨的公眾地方及設施、回收單位內外的裝修、布局、尺寸、實際情況及狀況作出任何保證。買方應到該屋邨作實地考察，以對該屋邨、其周邊環境及公共設施有較佳的了解。
  4. 本圖所列之數字為以毫米標示之尺寸。
  5. 大廈設有6部升降機，每個住宅樓層均有2部升降機到達。
  6. 大廈1至2樓單位前身為長者住屋，部份單位至今仍屬長者住屋。該些單位的信箱設於與單位同層的升降機大堂內。

- Notes :
1. This plan is prepared with reference to the records kept by the Independent Checking Unit of the Office of the Permanent Secretary for Transport and Housing (Housing), with adjustments where necessary.
  2. This plan is for identifying the locations and boundaries of the recovered TPS flats in the blocks only and does not aim to reflect the prevailing physical state and condition of the recovered TPS flats, other residential flats and the blocks. The existing layouts inside and outside the recovered TPS flats or other residential flats and the common facilities in the blocks may differ from these records and this plan. Purchasers may refer to the photos and videos (if any) provided by the HA during the flat selection period for a better understanding of the recovered TPS flats.
  3. The HA is not responsible for the management of the common parts and facilities of the estate and those sold residential flats. The recovered TPS flats are sold on an "as-is" basis and in the physical state and condition as they stand. No warranty whatsoever has been given or is made by the HA regarding the common parts and facilities of the estate, and the decoration, layout, dimensions, physical state and condition inside and outside the recovered TPS flats. Purchasers should conduct an on-site visit for a better understanding of the estate, its surrounding environment and the public facilities.
  4. The dimensions on the floor plan are all in millimetres.
  5. There are 6 lifts in the building, each residential floor is served by 2 lifts.
  6. Flats on the 1/F and 2/F were former Housing for Senior Citizens and some of them remain unchanged. Letter boxes of these flats are provided at the lift lobbies on the same floors of the flats.



屋邨的住宅物業的樓面平面圖  
Floor Plans of Residential Properties in the Estate

德隆樓(第8座)  
3樓至34樓平面圖  
TAK LUNG HOUSE (BLOCK 8)  
3/F-34/F FLOOR PLAN

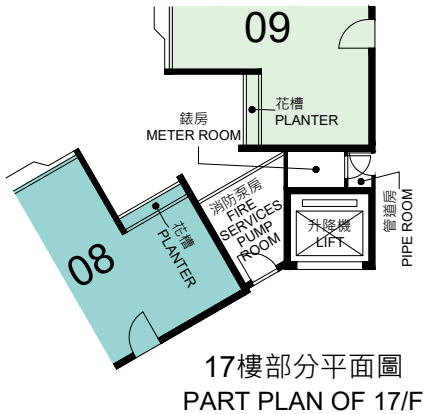
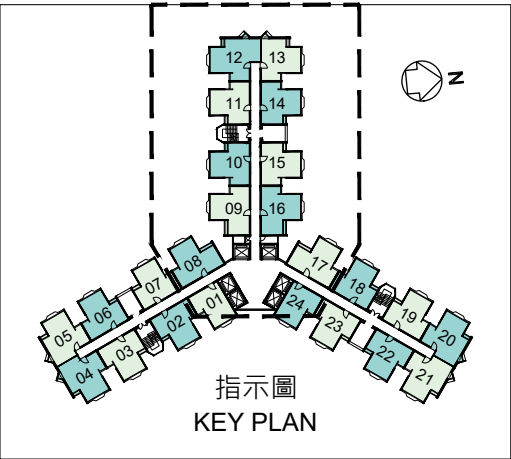

比例尺 SCALE: 0 5(米)  
(m)



樓宇平面圖摘錄自為出售租者置其屋計劃屋邨回收單位而於2021年9月印製的德田邨售樓小冊子，只供參考。個別樓層（如平面圖覆蓋多於一樓層）或單位的圖則跟上述平面圖或有差異，擬於居屋第二市場購買單位人士在購買單位前，應實地參觀並了解擬選購單位的現狀。  
The floor plan is extracted from the sales pamphlet of Tak Tin Estate printed in September 2021 for the sale of Recovered Flats from Estates under Tenants Purchase Scheme and is for reference only. The plan of individual floor (if the floor plan covers more than one floor) or flat may vary from the above floor plan. Prior to purchasing a flat in the HOS Secondary Market, prospective purchaser should carry out on-the-spot visit to get to know the existing condition of the flat.

圖例 NOTATION

BATH	浴室	Bathroom
KIT	廚房	Kitchen
BAL	露台	Balcony

- 註：
1. 本圖參考備存於運輸及房屋局常任秘書長(房屋)辦公室的獨立審查組的資料紀錄製作，有需要處經修正處理。
  2. 本圖只用作顯示租置計劃回收單位(下稱「回收單位」)在樓宇內的位置和界線，並不在反映回收單位、其他住宅單位及樓宇目前的實際情況及狀況。回收單位或其他住宅單位內外的現場布局及樓宇內的公眾設施可能與這些資料紀錄及本圖有所不同。買方可參考由房委會於選購單位期間提供的回收單位照片和錄像短片(如有)，以便對回收單位有較佳的了解。
  3. 房委會並不負責管理該屋邨的公眾地方及設施，以及已經出售的住宅單位。回收單位是按「現有」狀況及其現時的實際情況及狀況出售。房委會沒有亦不會就該屋邨的公眾地方及設施、回收單位內外的裝修、布局、尺寸、實際情況及狀況作出任何保證。買方應到該屋邨作實地考察，以對該屋邨、其周邊環境及公共設施有較佳的了解。
  4. 本圖所列之數字為以毫米標示之尺寸。
  5. 大廈設有6部升降機，每個住宅樓層均有2部升降機到達。
  6. 本圖為標準樓層平面圖，不同樓層的公眾地方的布局或會有所不同。
  7. 本圖所顯示的錶櫃只設在3樓至26樓。

- Notes :
1. This plan is prepared with reference to the records kept by the Independent Checking Unit of the Office of the Permanent Secretary for Transport and Housing (Housing), with adjustments where necessary.
  2. This plan is for identifying the locations and boundaries of the recovered TPS flats in the blocks only and does not aim to reflect the prevailing physical state and condition of the recovered TPS flats, other residential flats and the blocks. The existing layouts inside and outside the recovered TPS flats or other residential flats and the common facilities in the blocks may differ from these records and this plan. Purchasers may refer to the photos and videos (if any) provided by the HA during the flat selection period for a better understanding of the recovered TPS flats.
  3. The HA is not responsible for the management of the common parts and facilities of the estate and those sold residential flats. The recovered TPS flats are sold on an "as-is" basis and in the physical state and condition as they stand. No warranty whatsoever has been given or is made by the HA regarding the common parts and facilities of the estate, and the decoration, layout, dimensions, physical state and condition inside and outside the recovered TPS flats. Purchasers should conduct an on-site visit for a better understanding of the estate, its surrounding environment and the public facilities.
  4. The dimensions on the floor plan are all in millimetres.
  5. There are 6 lifts in the building, each residential floor is served by 2 lifts.
  6. This plan is a typical floor plan, layout of common area on other floors may be different.
  7. Meter Boards shown on this plan are only provided on 3/F to 26/F.

樓宇平面圖摘錄自為出售租者置其屋計劃屋邨回收單位而於2021年9月印製的德田邨售樓小冊子，只供參考。個別樓層（如平面圖覆蓋多於一樓層）或單位的圖則跟上述平面圖或有差異，擬於居屋第二市場購買單位人士在購買單位前，應實地參觀並了解擬選購單位的現狀。

The floor plan is extracted from the sales pamphlet of Tak Tin Estate printed in September 2021 for the sale of Recovered Flats from Estates under Tenants Purchase Scheme and is for reference only. The plan of individual floor (if the floor plan covers more than one floor) or flat may vary from the above floor plan. Prior to purchasing a flat in the HOS Secondary Market, prospective purchaser should carry out on-the-spot visit to get to know the existing condition of the flat.

屋邨的住宅物業的樓面平面圖  
Floor Plans of Residential Properties in the Estate

德隆樓(第8座)  
3樓至34樓平面圖  
TAK LUNG HOUSE (BLOCK 8)  
3/F-34/F FLOOR PLAN



- 註：
1. 本圖參考備存於運輸及房屋局常任秘書長(房屋)辦公室的獨立審查組的資料紀錄製作，有需要處經修正處理。
  2. 本圖只用作顯示租置計劃回收單位(下稱「回收單位」)在樓宇內的位置和界線，並不旨在反映回收單位、其他住宅單位及樓宇目前的實際情況及狀況。回收單位或其他住宅單位內外的現場布局及樓宇內的公眾設施可能與這些資料紀錄及本圖有所不同。買方可參考由房委會於選購單位期間提供的回收單位照片和錄像短片(如有)，以便對回收單位有較佳的了解。
  3. 房委會並不負責管理該屋邨的公眾地方及設施，以及已經出售的住宅單位。回收單位是按「現有」狀況及其現時的實際情況及狀況出售。房委會沒有亦不會就該屋邨的公眾地方及設施、回收單位內外的裝修、布局、尺寸、實際情況及狀況作出任何保證。買方應到該屋邨作實地考察，以對該屋邨、其周邊環境及公共設施有較佳的了解。
  4. 本圖所列之數字為以毫米標示之尺寸。
  5. 大廈設有6部升降機，每個住宅樓層均有2部升降機到達。
  6. 本圖為標準樓層平面圖，不同樓層的公眾地方的布局或會有所不同。
  7. 本圖所顯示的錶櫃只設在3樓至26樓。

- Notes:
1. This plan is prepared with reference to the records kept by the Independent Checking Unit of the Office of the Permanent Secretary for Transport and Housing (Housing), with adjustments where necessary.
  2. This plan is for identifying the locations and boundaries of the recovered TPS flats in the blocks only and does not aim to reflect the prevailing physical state and condition of the recovered TPS flats, other residential flats and the blocks. The existing layouts inside and outside the recovered TPS flats or other residential flats and the common facilities in the blocks may differ from these records and this plan. Purchasers may refer to the photos and videos (if any) provided by the HA during the flat selection period for a better understanding of the recovered TPS flats.
  3. The HA is not responsible for the management of the common parts and facilities of the estate and those sold residential flats. The recovered TPS flats are sold on an "as-is" basis and in the physical state and condition as they stand. No warranty whatsoever has been given or is made by the HA regarding the common parts and facilities of the estate, and the decoration, layout, dimensions, physical state and condition inside and outside the recovered TPS flats. Purchasers should conduct an on-site visit for a better understanding of the estate, its surrounding environment and the public facilities.
  4. The dimensions on the floor plan are all in millimetres.
  5. There are 6 lifts in the building, each residential floor is served by 2 lifts.
  6. This plan is a typical floor plan, layout of common area on other floors may be different.
  7. Meter Boards shown on this plan are only provided on 3/F to 26/F.