

## 樓宇樣本平面圖

天平邨天明樓 3 樓至 17 樓

## Typical Floor Plan

Tin Ping Estate Tin Ming House 3/F-17/F

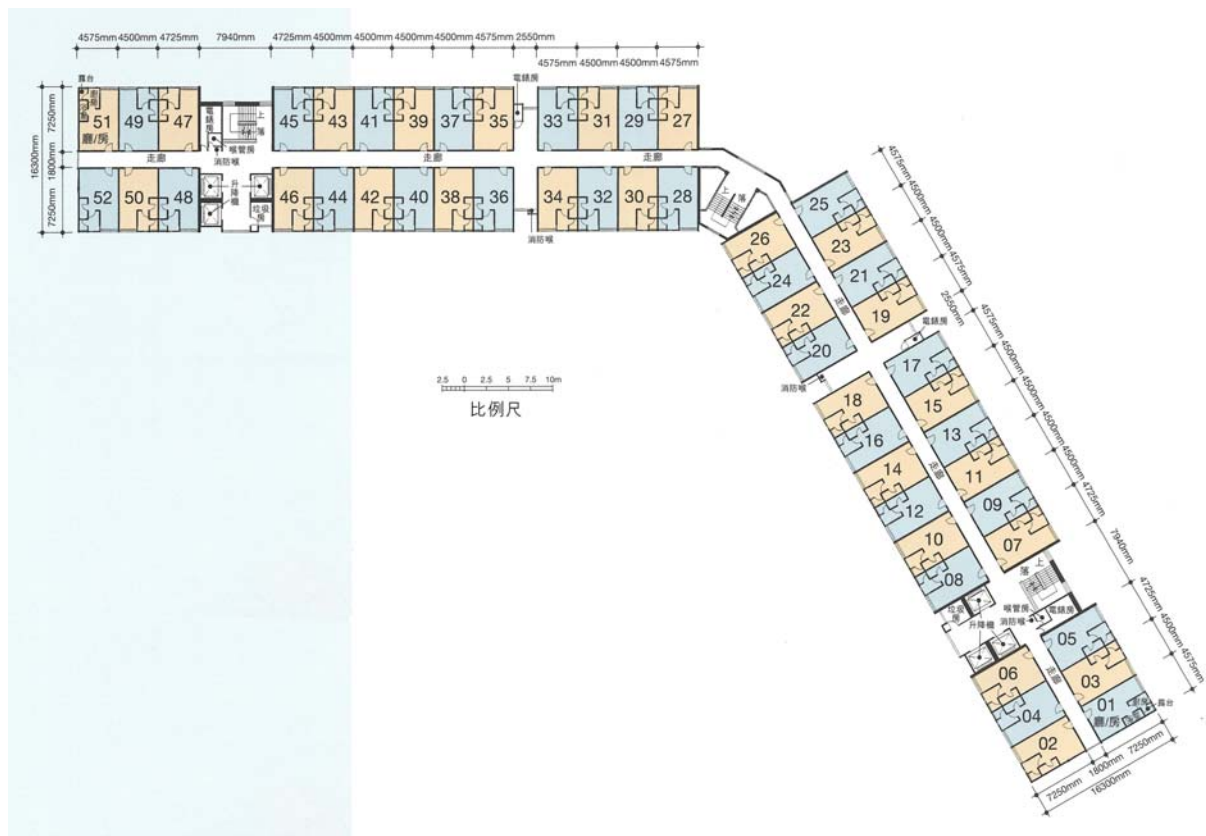

樓宇樣本平面圖、附圖摘錄自2000年1月印製的租者置其屋計劃第3期的天平邨售樓概要,只供參考。圖則只顯示標準樓層的樣本平面圖,個別樓層或單位的圖則跟上述平面圖或有差異,擬購買單位人士在購買單位前,應實地參觀並了解擬選購單位的現狀。

The typical floor plan, part plan are extracted from the sales brochure of Tin Ping Estate under the Tenants Purchase Scheme Phase 3 printed in January 2000 and are for reference only. The plan of individual floor or flat may vary from the above typical floor plan. Prior to purchasing a flat, prospective purchaser should carry out on-the-spot visit to get to know the existing condition of the flat.