

樓宇樣本平面圖

天祐苑祐寧閣 (B座) 1樓至38樓

Typical Floor Plan

Tin Yau Court Yau Ning House (Block B)
1/F-38/F

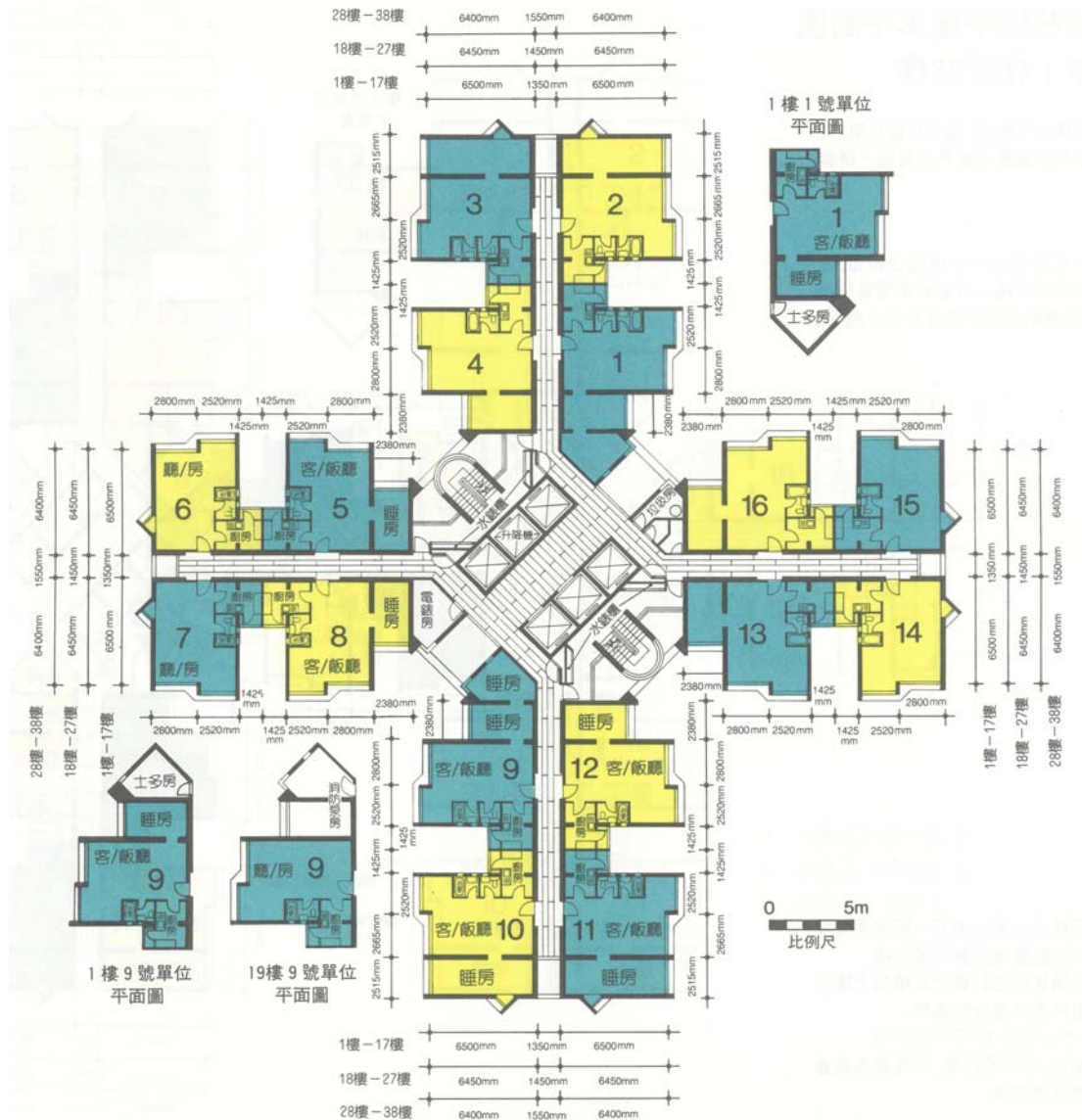

樓宇樣本平面圖、附圖摘錄自1992年4月印製的居者有其屋計劃第14期甲的天祐苑售樓書,只供參考。擬購買單位人士在購買單位前,應實地參觀並了解擬選購單位的現狀。

The typical floor plan, part plan are extracted from the sales brochure of Tin Yau Court under the Home Ownership Scheme Phase 14A printed in April 1992 and are for reference only. Prior to purchasing a flat, prospective purchaser should carry out on-the-spot visit to get to know the existing condition of the flat.