

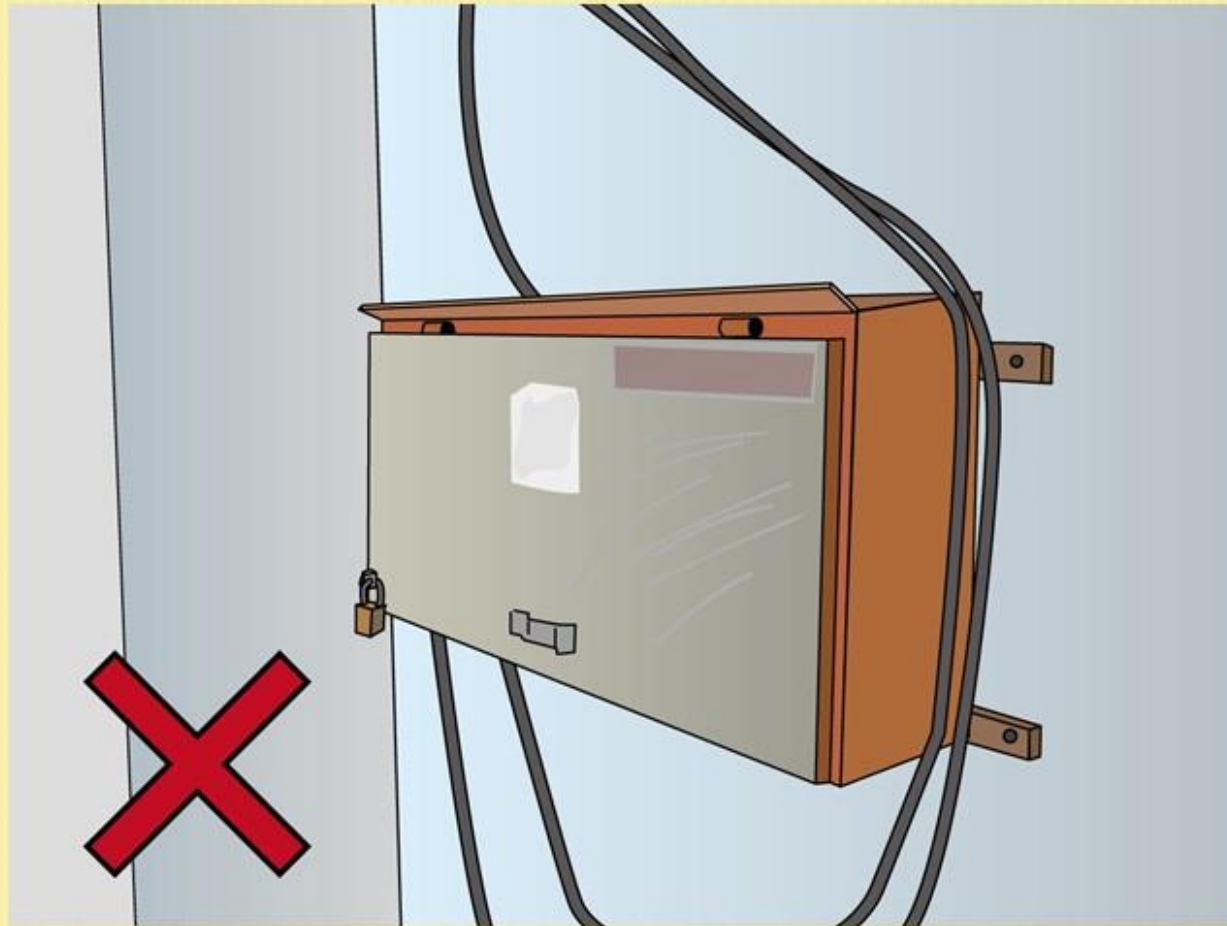

ELECTRICAL SUPPLY SYSTEM
供電系統

67

未有張貼電擊告示、註冊電工等資料 NOTICE OF
ELECTRIC SHOCK, REW NAMES AND CONTACT NOT
DISPLAYED



電源線插頭損壞。110V 的插頭連接到 220V 的插座。

CORD GUARDS WERE DAMAGED AND IMPROPER CONNECTION OF SOCKET PLUG.

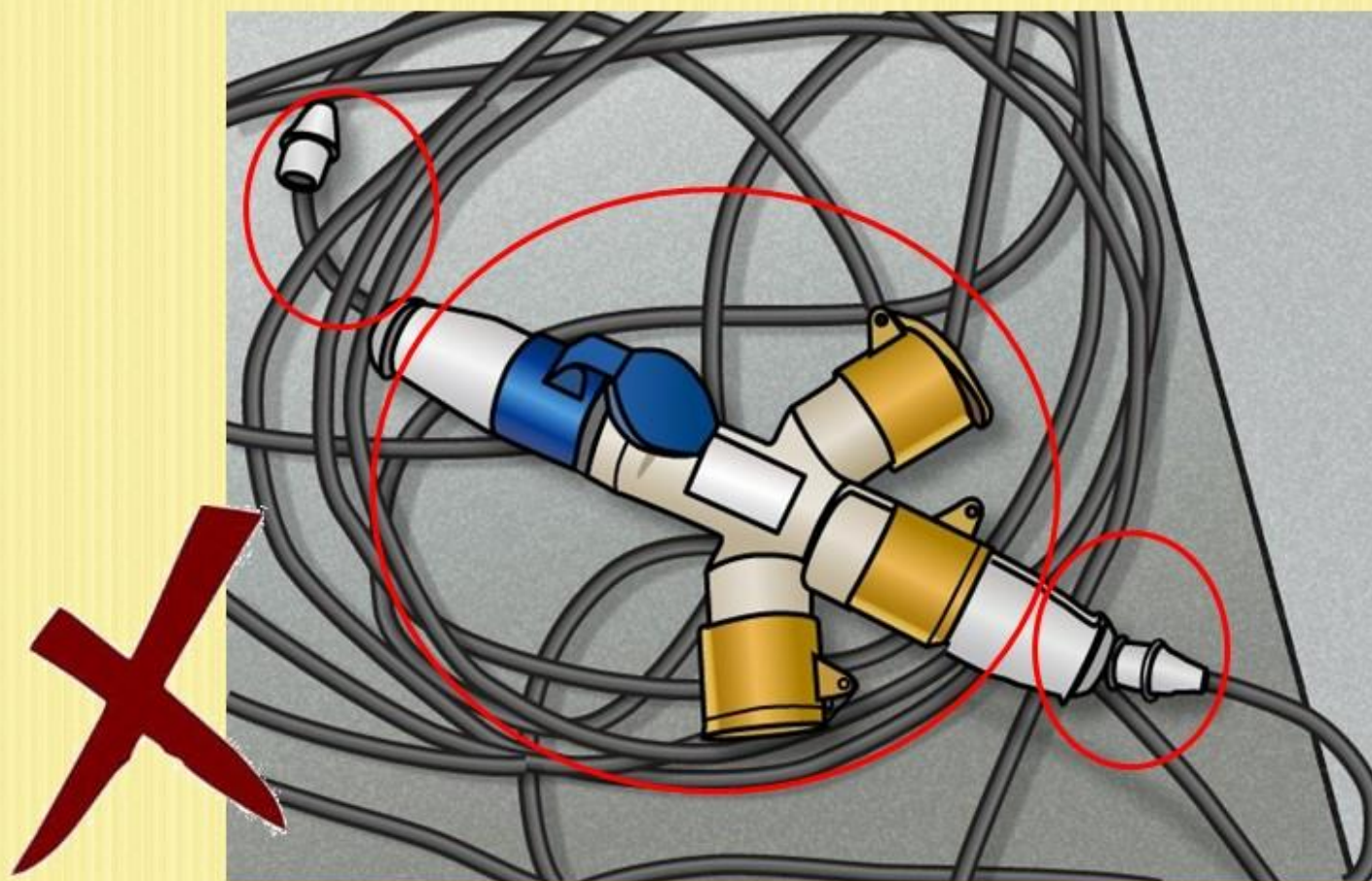

220V的手提工具使用110V的插頭。

220V HAND-HELD TOOLS WERE FOUND WITH 110V SOCKET.

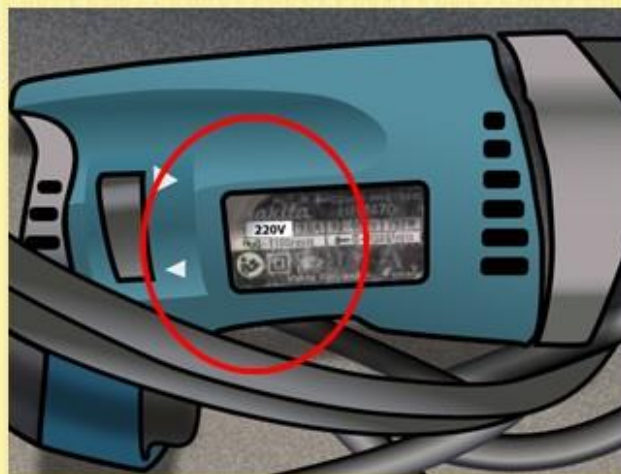
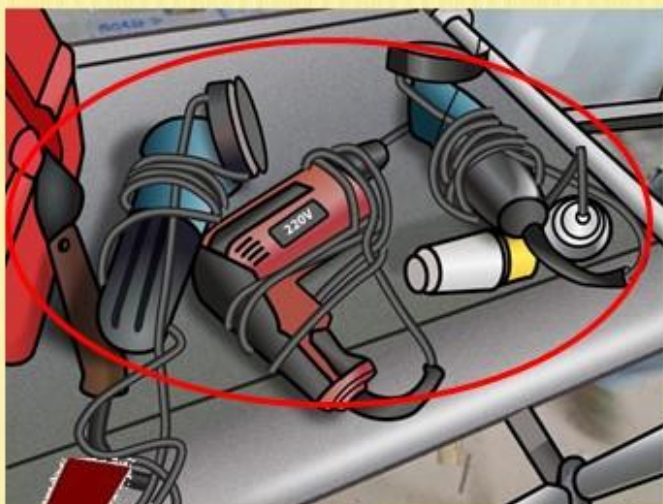

電線拖地，有絆倒的危險。

TRIPPING HAZARD WAS FOUND FOR THE TRAILING CABLE. TRAILING CABLE WAS FOUND.



機手可能看不清楚泥坑內情況，但工友在沒有訊號員的情況下在泥坑內工作。

OPERATOR OF THE EXCAVATOR MAY NOT HAVE UNOBSTRUCTED VIEW OF THE WHOLE PIT AND THE MOVING BUCKET MAY HIT THE WORKER. WORKER SHOULD AVOID WORKING IN EXCAVATION WHEN EXCAVATOR IS OPERATING NEARBY WITHOUT A SIGNALLER.

